

SQUARE SHOULDER CUTTERS

	D	a	Description	Code	Page
	32 - 40	5,7	HIPOS MICRO EA06D10	EA06D10	50
	32 - 100	9	HIPOS PLUS EB09D10A	EB09D10A	51
	32 - 100	9	HIPOS PLUS EB09D10	EB09D10	52
	35 - 125	12	HIPOS PLUS EB13D10B	EB13D10B	54
	32 - 63	3,8	EBO 6 EW04D10	EW04D10	56
	40 - 125	5,8	EBO 6 EW06D10	EW06D10	57
	40 - 80	7,5	HIPOS QUAD ES08D10	ES08D10	58
	50 - 160	11,3	HIQUAD ES13D10	ES13D10	59
	50 - 100	8,4	ALUMINATOR ES11D10	ES11D10	60
	50 - 160	8,7	SUPER 8 ES09D10	ES09D10	61

Subject to printing error or technical changes.

SQUARE SHOULDER CUTTERS

	D	a	Description	Code	Page

Subject to printing error or technical changes.



SQUARE SHOULDER CUTTERS

ADAPTION ACC. TO DIN 8030

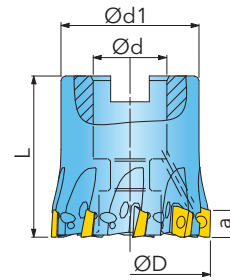

Designation	D	d	d1	L	a	Z			
EA.032.003	32	16	30	32	5,7	8	1,6	✓	0,11
EA.035.002	35	16	30	35	5,7	9	1,4	✓	0,14
EA.040.005	40	22	38	40	5,7	10	1,2	✓	0,22

Programming radius 1mm

AOMT060202R 	AOMT060204R 	AOMT060208R
AOMT060216R 	AOCT060204FR-P 	AOMT060202R-DT1
UOMT0602TR 		

Designation	fz(min/max)	Design	Grade	IN05S	IN2035	IN2504	IN2505	IN2530	IN90D
AOMT060202R	0,06/0,12	positive geometry R0,2							
AOMT060204R	0,06/0,12	positive geometry R0,4							
AOMT060208R	0,06/0,12	positive geometry R0,8							
AOMT060216R ¹⁾	0,06/0,12	positive geometry R1,6							
AOCT060204FR-P	0,05/0,12	non-ferrous geometry, polished R0,4							
AOMT060202R-DT1	0,05/0,12	with short PCD-tip R0,2							
UOMT0602TR	0,30/0,80	high feed geometry							

¹⁾ Cutter body has to be modified

● = P ● = M ● = K ● = N ● = S ○ = H



SM18-041-00 (0,5Nm) DS-TP06S (TX-Plus)

① = Insert screw ② = Screw driver

HIPOS MICRO EA06D10

SQUARE SHOULDER CUTTERS

ADAPTION ACC. TO DIN 8030

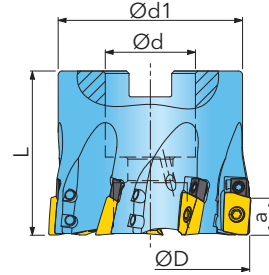
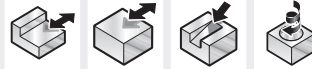

Designation	D	d	d1	L	a	Z	IK	kg
EB.032.002	32	16	30	32	9	5	✓	0,09
EB.040.005	40	16	30	40	9	6	✓	0,16
EB.050.004	50	22	45	40	9	7	✓	0,32
EB.063.004	63	22	55	40	9	8	✓	0,56
EB.080.003	80	27	70	50	9	10	✓	1,30
EB.100.004	100	32	85	50	9	13	✓	1,95

BOCT090304FR-P 	BOCT090308FR-P 	BODT09T304R
BODT09T304R-001 	BODT09T308R 	BODT09T308R-001
BODT09T320R-001 	BOMT09T304R-DT1 	BOMT09T304R-DT2

Designation	fz(min/max)	Design	Grade	IN10K	IN0560	IN2504	IN90D				
BOCT090304FR-P	0,05/0,20	non-ferrous geometry, polished R0,4		●							
BOCT090308FR-P	0,05/0,20	non-ferrous geometry, polished R0,8		●							
BODT09T304R	0,05/0,15	ground finishing geometry R0,4			●	●					
BODT09T304R-001	0,05/0,15	finishing geometry, short R0,4			●	●					
BODT09T308R	0,05/0,15	ground finishing geometry R0,8			●	●					
BODT09T308R-001	0,05/0,15	finishing geometry, short R0,8			●	●					
BODT09T320R-001	0,05/0,15	finishing geometry, short R2,0			●	●					
BOMT09T304R-DT1	0,05/0,20	with short PCD-tip R0,4					●				
BOMT09T304R-DT2	0,05/0,20	with long PCD-tip R0,4					●				

● = P ● = M ● = K ● = N ● = S ○ = H

SPARE PARTS	①	②	③	④	⑤
	SM25-064-00 (1,1Nm) DS-T08S		PAR5092	SB025-00	DS-T05F

① = Insert screw ② = Screw driver ③ = Wedge ④ = Differential screw ⑤ = Screw driver

SQUARE SHOULDER CUTTERS

ADAPTION ACC. TO DIN 8030

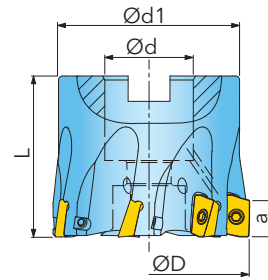
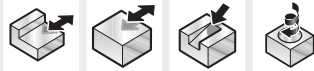

Designation	D	d	d1	L	a	Z			
EB.032.003	32	16	30	32	9	4	2,8	✓	0,09
EB.032.001	32	16	30	32	9	5	2,8	✓	0,09
EB.035.002	35	16	30	32	9	6	2,5	✓	0,10
EB.040.006	40	16	30	40	9	4	2,4	✓	0,15
EB.040.004	40	16	30	40	9	6	2,4	✓	0,16
EB.050.005	50	22	45	40	9	4	1,3	✓	0,32
EB.050.007	50	22	45	40	9	6	1,3	✓	0,32
EB.050.003	50	22	45	40	9	7	1,3	✓	0,32
EB.063.005	63	22	55	40	9	6	1,0	✓	0,55
EB.063.003	63	22	55	40	9	8	1,0	✓	0,55
EB.080.005	80	27	70	50	9	10	0,6	✓	1,25
EB.100.005	100	32	85	50	9	12	0,5	✓	1,95

HIPOS PLUS EB09D10

SPARE PARTS



SM25-064-00 (1,1Nm) DS-T08S

① = Insert screw ② = Screw driver

SQUARE SHOULDER CUTTERS



Designation	fz(min/max)	Design	Grade	IN10K	IN0560	IN2035	IN2504	IN2505	IN2530	IN4030	IN90D
BOMT09T304R	0,10/0,15	positive geometry R0,4				●	●	●	●		
BOMT09T308R	0,10/0,15	positive geometry R0,8				●	●	●	●	●	
BOMT09T316R ¹⁾	0,10/0,15	positive geometry R1,6				●		●	●		
BOMT09T320R ¹⁾	0,10/0,15	positive geometry R2,0				●		●	●		
BOMT09T331R ¹⁾	0,10/0,15	positive geometry R3,1				●		●	●		
BOCT090304FR-P	0,05/0,20	non-ferrous geometry, polished R0,4		●							
BOCT090308FR-P	0,05/0,20	non-ferrous geometry, polished R0,8		●							
BOMT09T304R-DT1	0,05/0,20	with short PCD-tip R0,4									●
BOMT09T304R-DT2	0,05/0,20	with long PCD-tip R0,4									●
BODT09T304R	0,05/0,15	ground finishing geometry R0,4			●		●				
BODT09T304R-001	0,05/0,15	finishing geometry, short R0,4			●		●				
BODT09T308R	0,05/0,15	ground finishing geometry R0,8			●		●				
BODT09T308R-001	0,05/0,15	finishing geometry, short R0,8			●		●				
BODT09T320R-001	0,05/0,15	finishing geometry, short R2,0			●		●				
ZOMT09T304R ²⁾	0,10/0,15	chip splitter geometry R0,4				●		●	●	●	

¹⁾Cutter body has to be modified; ²⁾Best results are achieved on tools with an even number of teeth. Please mount inserts alternating. ● = P ● = M ● = K ● = N ● = S ○ = H

SQUARE SHOULDER CUTTERS

ADAPTION ACC. TO DIN 8030

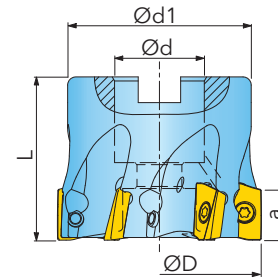
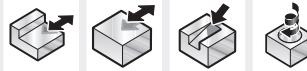

Designation	D	d	d1	L	a	Z			
EB.035.001	35	16	30	35	12	4	4,2	✓	0,10
EB.040.007	40	16	38	40	12	4	3,2	✓	0,22
EB.040.002	40	16	38	40	12	5	3,2	✓	0,21
EB.040.008	40	22	38	40	12	4	3,2	✓	0,18
EB.040.003	40	22	38	40	12	5	3,2	✓	0,18
EB.050.006	50	22	45	40	12	4	2,1	✓	0,29
EB.050.002	50	22	45	40	12	6	2,1	✓	0,30
EB.052.001	52	22	40	50	12	5	2,0	✓	0,37
EB.063.006	63	22	55	40	12	6	1,4	✓	0,54
EB.063.002	63	22	55	40	12	7	1,4	✓	0,54
EB.066.001	66	27	48	50	12	6	1,2	✓	0,60
EB.080.004	80	27	70	50	12	6	1,0	✓	1,21
EB.080.002	80	27	70	50	12	9	1,0	✓	1,20
EB.085.001	85	27	70	50	12	7	0,9	✓	1,33
EB.100.003	100	32	85	50	12	8	0,8	✓	1,88
EB.100.002	100	32	85	50	12	11	0,8	✓	1,89
EB.125.003	125	40	100	63	12	10	0,6	✓	3,70
EB.125.002	125	40	100	63	12	13	0,6	✓	3,76

HIPOS PLUS EB13D10B

SPARE PARTS



SM35-088-10 (3,0Nm) DS-T10S

① = Insert screw ② = Screw driver

SQUARE SHOULDER CUTTERS



Designation	fz(min/max)	Design	Grade									
				IN10K	IN0560	IN2035	IN2504	IN2505	IN2530	IN4030	IN90D	
BOMT130404R	0,12/0,20	positive geometry R0,4					●	●	●	●	●	
BOMT130408R	0,12/0,20	positive geometry R0,8					●	●	●	●	●	
BOMT130416R	0,12/0,20	positive geometry R1,6						●	●	●	●	
BOMT130420R	0,12/0,20	positive geometry R2,0						●	●	●	●	
BOMT130424R ¹⁾	0,12/0,20	positive geometry R2,4						●	●	●	●	
BOMT130431R ¹⁾	0,12/0,20	positive geometry R3,1				●		●	●	●	●	
BOMT130440R ¹⁾	0,12/0,20	positive geometry R4,0						●	●	●	●	
BOCT130404FR-P	0,05/0,25	non-ferrous geometry, polished R0,4	●									
BOCT130408FR-P	0,05/0,25	non-ferrous geometry, polished R0,8	●									
BOMT130404R-DT2	0,05/0,25	with long PCD-tip R0,4										●
BODT130404R	0,05/0,20	ground finishing geometry R0,4		●				●				
BODT130404R-001	0,05/0,20	finishing geometry, short R0,4		●				●				
BODT130408R	0,05/0,20	ground finishing geometry R0,8		●				●				
BODT130408R-001	0,05/0,20	finishing geometry, short R0,8		●				●				
ZOMT130404R ²⁾	0,12/0,20	chip splitter geometry R0,4				●		●	●	●	●	

¹⁾Cutter body has to be modified; ²⁾Best results are achieved on tools with an even number of teeth. Please mount inserts alternating. ● = P ● = M ● = K ● = N ● = S ○ = H

SQUARE SHOULDER CUTTERS

ADAPTION ACC. TO DIN 8030

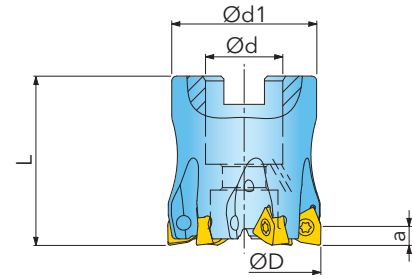
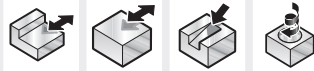

Designation	D	d	d1	L	a	Z			
EW.032.001 ¹⁾	32	16	30	35	3,8	6	1,5	✓	0,13
EW.040.006 ¹⁾	40	16	30	40	3,8	7	2,1	✓	0,18
EW.040.005	40	16	30	40	3,8	5	2,1	✓	0,18
EW.040.004 ¹⁾	40	22	38	40	3,8	7	2,1	✓	0,23
EW.040.003	40	22	38	40	3,8	5	2,1	✓	0,23
EW.050.006 ¹⁾	50	22	45	40	3,8	9	2,5	✓	0,35
EW.050.005	50	22	45	40	3,8	6	2,5	✓	0,36
EW.063.006 ¹⁾	63	22	55	40	3,8	11	2,4	✓	0,62
EW.063.005	63	22	55	40	3,8	8	2,4	✓	0,61

¹⁾Narrow spacing (only for short chip producing materials)

Designation	fz(min/max)	Design	Grade	IN10K	IN2035	IN2504	IN2505	IN2530	IN4030
WNMU04T302N	0,07/0,18	positive geometry R0,2							
WNMU04T304N	0,07/0,18	positive geometry R0,4							
WNCU04T302FN-P	0,05/0,20	non-ferrous geometry R0,2							
WNCU04T304FN-P	0,05/0,20	non-ferrous geometry R0,4							
WNCU04T308FN-P	0,05/0,20	non-ferrous geometry R0,8							

● = P ● = M ● = K ● = N ● = S ○ = H

SPARE PARTS



SM25-064-00 (1,1Nm) DS-T08S

① = Insert screw ② = Screw driver

ECO 6 EW04D10

SQUARE SHOULDER CUTTERS

ADAPTION ACC. TO DIN 8030

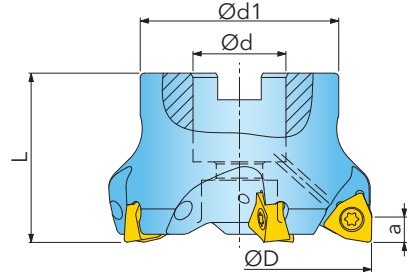

Designation	D	d	d1	L	a	Z			
EW.040.002 ¹⁾	40	16	38	40	5,8	4	1,8	✓	0,22
EW.050.003	50	22	45	40	5,8	4	1,7	✓	0,32
EW.050.004 ¹⁾	50	22	45	40	5,8	6	1,7	✓	0,31
EW.063.003	63	22	47	40	5,8	5	2,6	✓	0,45
EW.063.004 ¹⁾	63	22	47	40	5,8	7	2,6	✓	0,46
EW.080.003	80	27	58	50	5,8	7	2,9	✓	0,94
EW.080.004 ¹⁾	80	27	58	50	5,8	9	2,9	✓	0,94
EW.100.003	100	32	85	50	5,8	8	2,2	✓	1,80
EW.100.004 ¹⁾	100	32	85	50	5,8	11	2,2	✓	1,80
EW.125.003	125	40	85	63	5,8	10	1,3	✓	2,87
EW.125.004 ¹⁾	125	40	85	63	5,8	14	1,3	✓	2,87

¹⁾Narrow spacing (only for short chip producing materials)

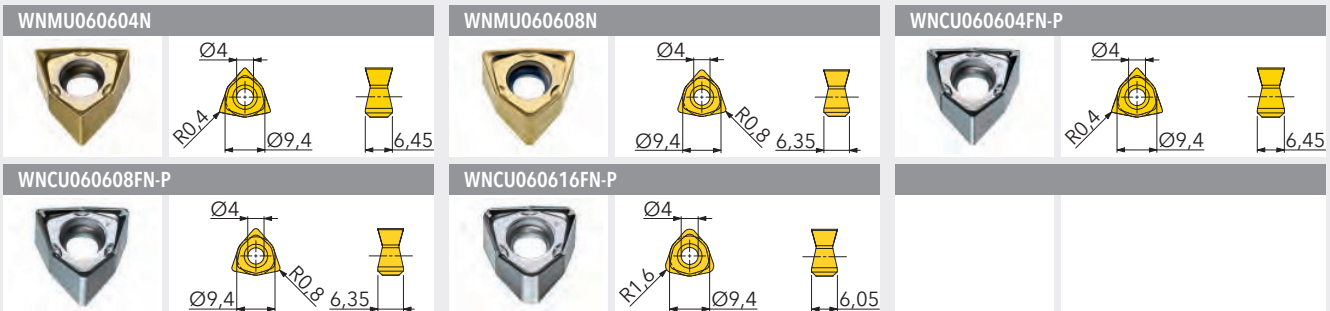

Designation	fz(min/max)	Design	Grade	IN10K	IN2035	IN2504	IN2505	IN2530	IN4030
WNMU060604N	0,13/0,35	positive geometry R0,4							
WNMU060608N	0,13/0,35	positive geometry R0,8							
WNCU060604FN-P	0,05/0,35	non-ferrous geometry R0,4							
WNCU060608FN-P	0,05/0,35	non-ferrous geometry R0,8							
WNCU060616FN-P	0,05/0,35	non-ferrous geometry R1,6							

● = P ● = M ● = K ● = N ● = S ○ = H

SPARE PARTS

① ②

SM35-088-60 (3,0Nm) DS-T10S

① = Insert screw ② = Screw driver

SQUARE SHOULDER CUTTERS

ADAPTION ACC. TO DIN 8030

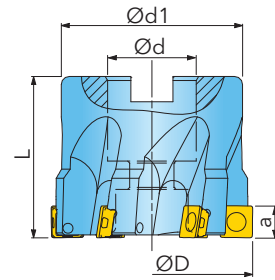
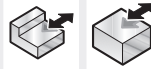

Designation	D	d	d1	L	a	Z		kg
ES.040.001	40	22	38	40	7,5	5	1,5	0,21
ES.050.002	50	22	45	40	7,5	6	1,2	0,34
ES.063.003	63	22	55	40	7,5	5	1,0	0,56
ES.063.002 ¹⁾	63	22	55	40	7,5	7	1,0	0,59
ES.080.004	80	27	70	50	7,5	7	0,5	1,26
ES.080.003 ¹⁾	80	27	70	50	7,5	9	0,5	1,25

¹⁾Narrow spacing (only for short chip producing materials)

SDMT080305N	SDMW080305TN	SDCT080305FN-P
SDMW080305TN-W		

Designation	fz(min/max)	Design	Grade	IN05S	IN2505	IN4030					
SDMT080305N	0,13/0,17	positive geometry R0,5									
SDMW080305TN	0,13/0,20	neutral geometry, K-land R0,5									
SDCT080305FN-P	0,05/0,20	non-ferrous geometry, polished R0,5									
SDMW080305TN-W	0,13/0,20	wiper insert R0,5									

● = P ● = M ● = K ● = N ● = S ○ = H



SM30-065-00 (2,0Nm) DS-T09S

① = Insert screw ② = Screw driver

HIPOS QUAD ES08D10

SQUARE SHOULDER CUTTERS

ADAPTION ACC. TO DIN 8030

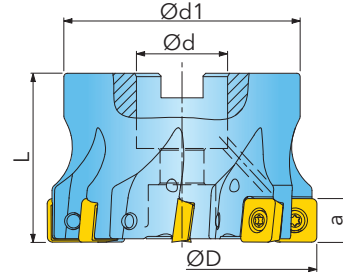

Designation	D	d	d1	L	a	Z			
ES.050.007	50	22	45	40	11,3	5	3,7	✓	0,30
ES.063.008	63	22	55	40	11,3	6	2,0	✓	0,48
ES.080.010	80	27	70	50	11,3	8	1,3	✓	1,06
ES.100.006	100	32	85	50	11,3	10	1,0	✓	1,70
ES.125.004	125	40	100	63	11,3	13	0,7	✓	3,20
ES.160.004	160	40	100	63	11,3	16	0,5	✓	4,42

* fz-values see manual „Cutting Data for Milling & Boring Tools“

SDES130515N 	SDES130515N-001 	SDMS130515R-PH
SDXS130515R-PH 	SDXS130515N-HR 	SDES130532R-001
SDES130540R-001 		

Designation	fz(min/max)	Design	Grade	IN2035	IN2505	IN2530	IN4030	IN4035			
SDES130515N	*/*	neutral geometry, K-land R1,5									
SDES130515N-001	*/*	neutral geometry, sharp R1,5									
SDMS130515R-PH	*/*	positive geometry, chamfered R1,5									
SDXS130515R-PH	*/*	positive geometry, chamfered R1,5									
SDXS130515N-HR	*/*	positive titanium geometry R1,5, K-land									
SDES130532R-001	*/*	neutral geometry, sharp R3,2									
SDES130540R-001 ¹⁾	*/*	neutral geometry, sharp R4,0									

¹⁾ Cutter body has to be modified

● = P ● = M ● = K ● = N ● = S ○ = H

SPARE PARTS		
	SM40-100-R0 (4,5Nm) DS-T15S	

① = Insert screw ② = Screw driver

HIQLAD ES13D10

SQUARE SHOULDER CUTTERS

ADAPTION ACC. TO DIN 8030

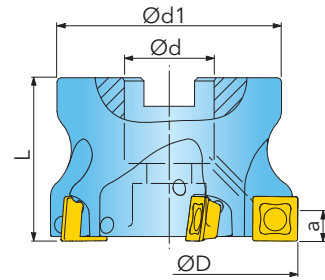
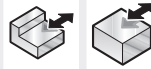

Designation	D	d	d1	L	a	Z			
ES.050.004	50	22	45	40	8,4	4	2,0	✓	0,24
ES.063.005	63	22	55	40	8,4	5	1,0	✓	0,45
ES.080.007	80	27	70	50	8,4	7	0,5	✓	1,08
ES.100.004	100	32	85	50	8,4	9	0,5	✓	1,72

SHET110502FR-P

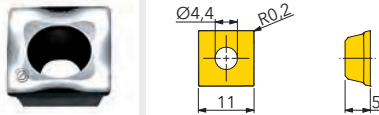

SHET110505FR-P

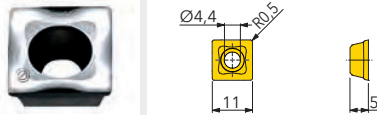

SHET110508FR-P

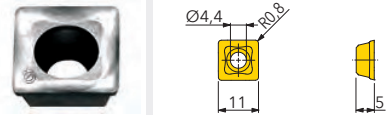

SHET110516FR-P

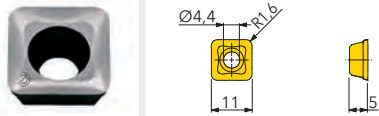

SHET110524FN-P

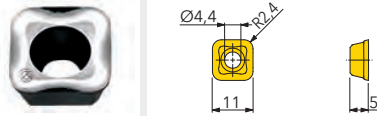

SHET110532FN-P

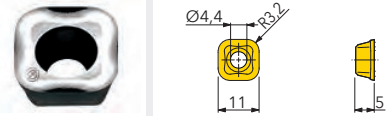

SHET110540FN-P

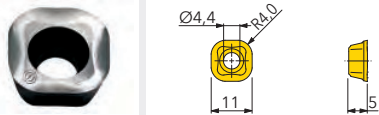

Designation	fz(min/max)	Design	Grade	IN15K							
SHET110502FR-P	0,05/0,30	non-ferrous geometry, polished R0,2		●							
SHET110505FR-P	0,05/0,30	non-ferrous geometry, polished R0,5		●							
SHET110508FR-P	0,05/0,30	non-ferrous geometry, polished R0,8		●							
SHET110516FR-P	0,05/0,30	non-ferrous geometry, polished R1,6		●							
SHET110524FN-P	0,05/0,30	non-ferrous geometry, polished R2,4		●							
SHET110532FN-P	0,05/0,30	non-ferrous geometry, polished R3,2		●							
SHET110540FN-P	0,05/0,30	non-ferrous geometry, polished R4,0		●							

● = P ● = M ● = K ● = N ● = S ○ = H

SPARE PARTS



SM40-093-20 (4,5Nm) DS-T15S

① = Insert screw ② = Screw driver

ALUMINATOR ES11D10

SQUARE SHOULDER CUTTERS

ADAPTION ACC. TO DIN 8030

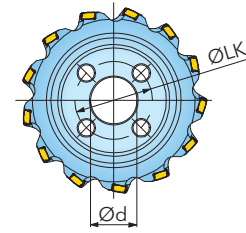
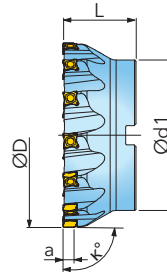
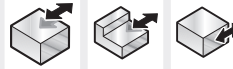

Designation	D	d	d1	LK	L	κ	a	Z		
ES.050.008 ¹⁾	50	22	45	-	40	90	8,7	6	✓	0,39
ES.050.004	50	22	45	-	40	90	8,7	5	✓	0,37
ES.063.009 ¹⁾	63	22	55	-	40	90	8,7	8	✓	0,65
ES.063.010	63	22	55	-	40	90	8,7	6	✓	0,63
ES.080.011 ¹⁾	80	27	70	-	50	90	8,7	10	✓	1,31
ES.080.012	80	27	70	-	50	90	8,7	8	✓	1,28
ES.100.006 ¹⁾	100	32	80	-	50	90	8,7	13	✓	2,02
ES.100.007	100	32	80	-	50	90	8,7	9	✓	1,93
ES.125.005 ¹⁾	125	40	100	-	63	90	8,7	16		4,00
ES.125.006	125	40	100	-	63	90	8,7	10		3,97
ES.160.005 ¹⁾	160	40	130	66,7	63	90	8,7	21		5,16
ES.160.006	160	40	130	66,7	63	90	8,7	13		4,90

¹⁾Narrow spacing (only for short chip producing materials)

SGM-44R001

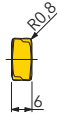
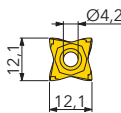

Designation	fz(min/max)	Design	Grade	IN2505	IN2530	IN4005	IN4015	IN4030			
SGM-44R001	0,10/0,25	positive geometry R0,8									

● = P ● = M ● = K ● = N ● = S ○ = H

SPARE PARTS



SM40-120-20 (4,5Nm) DS-T15S

① = Insert screw ② = Screw driver

SUPER 8 ES09D10